

## BS 464 Type Galvanised Heart Shaped Thimble

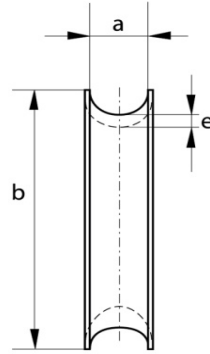
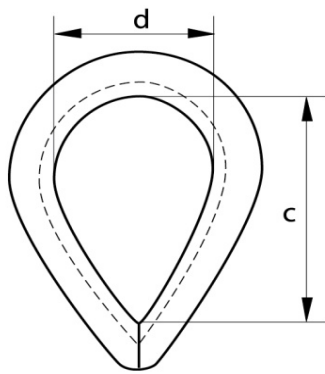

Diameter	Groove	Length	Inside	Inside	Back	Weight
Rope	Width		Length	Width	Thickness	Each
	a (min)	b	c	d	e (min)	
inch	mm	mm	mm	mm	mm	kg
1/4"	6	48	30	20	3.5	0.04
5/16"	8	54	33	22	4	0.05
3/8"	10	64	38	25	4.8	0.09
7/16"	13	73	41	29	4.8	0.11
1/2"	14	80	44	32	5.6	0.15
5/8"	17	98	59	41	7.9	0.25
3/4"	20	124	73	51	9.5	0.48
7/8"	23	133	83	57	9.5	0.6
1"	27	162	108	70	10.3	1.1
1.1/8"	29	178	111	76	12.7	1.4
1.1/4"	33	197	133	95	12.7	1.6
1.3/8"	38	229	152	105	15.9	2.3
1.1/2"	41	254	165	114	17.5	3.5
1.5/8"	43	254	165	114	17.5	4.5
1.3/4"	51	286	178	127	25.4	5.5
2"	64	330	203	140	28.6	8

Finish- Hot Dipped Galvanised