

Can also be delivered with:

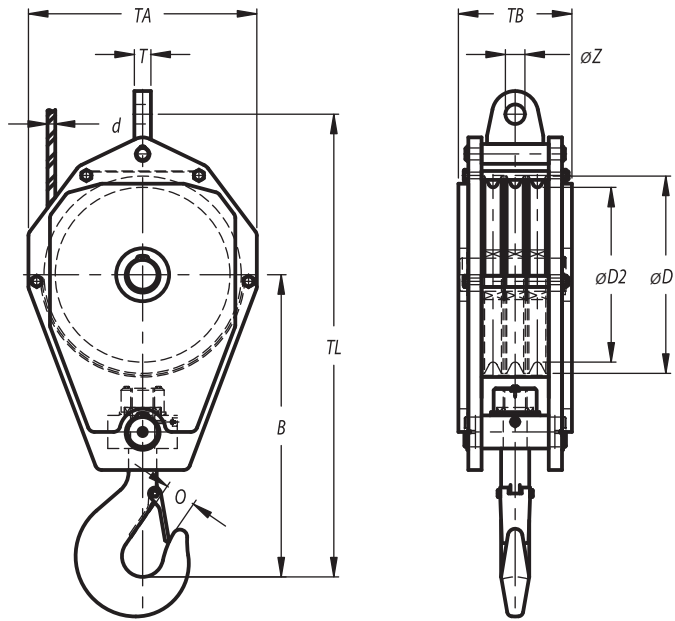

Stock No.	Model No.	WLL (t)	Wire d (mm)	Dimensions (mm)									Weight (kg)
				ØD1	ØD2	B	O	TA	TB	TL	T	ØZ	
22.280.016.31	SRB 250.3.16	16	11-12	280	250	640	59	360	220	910	22	27	175
22.320.020.31	SRB 285.3.20	20	13-14	320	285	700	69	400	230	995	28	32	200
22.365.025.31	SRB 320.3.25	25	15-16	365	320	725	69	450	230	1045	28	32	250
22.410.032.31	SRB 355.3.32	32	17-18	410	355	820	76	500	250	1160	35	37	310
22.460.040.31	SRB 400.3.40	40	19-20	460	400	940	84	570	292	1320	40	43	460
22.515.050.31	SRB 450.3.50	50	21-22	515	450	945	97	600	333	1355	40	43	600
22.595.063.31	SRB 520.3.63	63	24-26	595	520	980	97	700	333	1445	45	52	850
22.650.080.31	SRB 570.3.80	80	28-29	650	570	1195	110	750	372	1615	50	59	1100
22.720.100.31	SRB 630.3.100	100	30-32	720	630	1300	132	825	392	1770	60	65	1400

Minimum Ultimate Strength = 4 x WLL.

- Standard fitted with cylindrical roller bearing, reeving guide and becket.
- Standard painted in yellow with black stripes.
- Standard sheaves of reeve blocks can be adjusted to other wire rope diameters.
- Third party testing with certification available upon request.
- Standard fitted with hook according DIN 15401