

Can also be delivered with:

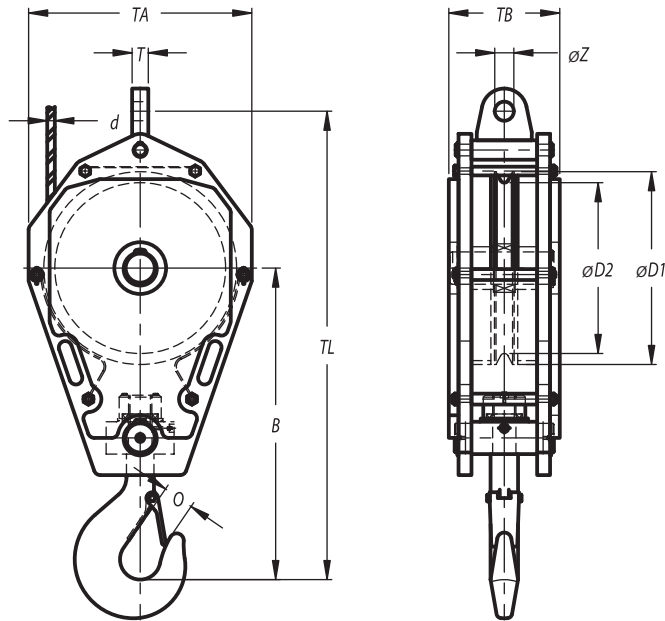

Stock No.	Model No.	WLL (t)	Wire d (mm)	Dimensions (mm)									Weight (kg)
				ØD1	ØD2	B	O	TA	TB	TL	T	ØZ	
23.280.008.11	FRB 250.1. 8	8	11-12	280	250	560	49	360	195	830	22	27	115
23.320.010.11	FRB 285.1.10	10	13-14	320	285	600	55	400	195	900	28	32	150
23.365.012.11	FRB 320.1.12	12	15-16	365	320	680	55	450	215	1005	28	32	200
23.410.016.11	FRB 355.1.16	16	17-18	410	355	730	59	500	215	1070	35	37	250
23.460.020.11	FRB 400.1.20	20	19-20	460	400	820	69	570	215	1200	40	43	300
23.515.025.11	FRB 450.1.25	25	21-22	515	450	895	69	600	230	1305	40	43	375
23.595.032.11	FRB 520.1.32	32	24-26	595	520	1000	76	700	230	1455	45	52	450
23.650.040.11	FRB 570.1.40	40	28-29	650	570	1150	84	750	335	1625	50	59	700
23.720.050.11	FRB 630.1.50	50	30-32	720	630	1220	97	850	335	1750	60	65	950

Minimum Ultimate Strength = 4 x WLL.

- Standard fitted with cylindrical roller bearing, reeving guide and becket.
- Standard painted in yellow with black stripes.
- Standard sheaves of reeve blocks can be adjusted to other wire rope diameters.
- Third party testing with certification available upon request.
- Standard fitted with hook according DIN 15401